

PRINTABLE INFO SHEET

Series: Westlake Ranch Homes

Model: 3W134A

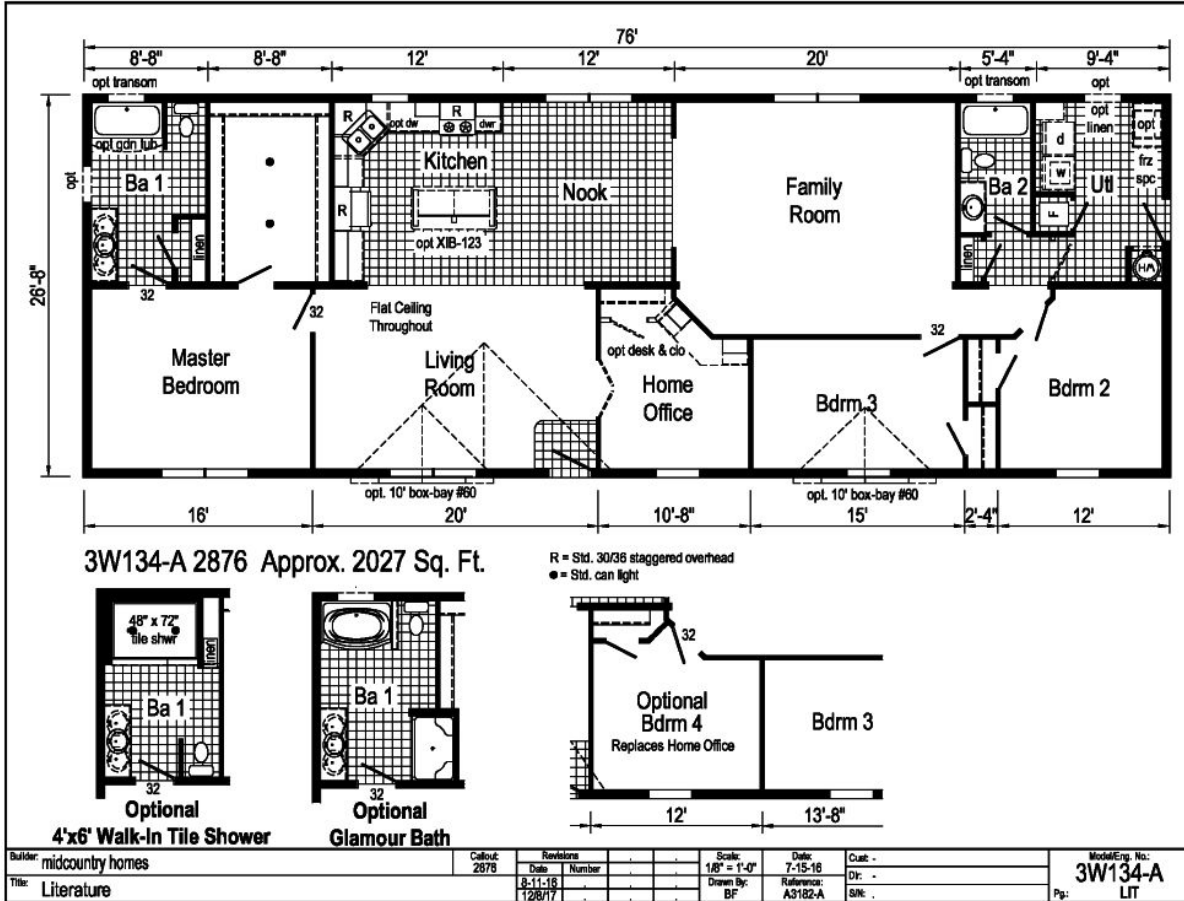

About This Model

Style: Ranch / Bedrooms: 3 / Bathrooms: 2 / Square Feet: 2027

CUSTOMER CONTACT

Notes:

PRINTABLE INFO SHEET

Series: Westlake Ranch Homes
Model: 3W134A



Standards & Features

Interior

- Primed Drywall Throughout
- Orange Peel Finish
- 8'-0" Flat Ceiling
- Orange Peel Finish
- Recessed LED Lights
- Black Dining Room Light
- 2-Panel White Painted
- Craftsman Interior Doors
- Pre-Hung Doors with Mortise Hinges
- Metal Interior Passage Sets
- Window Valances
- 1" Mini Blinds Throughout
- Smoke Detectors with Battery Back-Up
- Wire Shelving in Closets
- White Painted Mouldings Throughout
- 2 1/4" Window and Door Casing

Exterior

- Black Lantern Light at Front and Rear Door
- Vinyl Dutch Lap Siding
- Vinyl Insulated Windows with Low-E Glass
- Lineals Front Door Side
- GFI-Protected Exterior Receptacle at Each Exterior Door
- O.S.B. Sheathing
- Fixed Roof

Exterior (continued)

- 12" Overhangs & Eaves (Ranch)
- 4" Overhangs & 12" Eaves (Single)
- 3-Tab Shingles
- Ridge Vent Roof Ventilation System
- Ice Shield
- 3/0x6/8 Fiberglass 6-Panel Front & Rear Door w/ Deadbolt Keyed Alike Locksets

Construction

- Transverse Floor System on 16" Centers with 3/4" OSB Decking**
- 2x6 Floor Joist on 14 and 28 Wide Models
- 2x8 Floor Joist on 16 and 32 Wide Models
- 2x6 Exterior Walls on 16" Centers
- 82" Windows Headers
- 30# Roof Load

Kitchen

- Empire Brushed Nickel High Rise Faucet
- Stainless Steel Sink 33x22x8
- One USB Receptacle
- 30" Black Free-Standing Gas Range
- Power Range Hood with Fan & Light
- 18 Cu. Ft. Black Frost-Free Double Door Refrigerator

CUSTOMER CONTACT

Notes:

PRINTABLE INFO SHEET

Series: Westlake Ranch Homes
Model: 3W134A



Standards & Features (continued)

Baths

60" Fiberglass Tub/Showers
Tub/Shower Curtain & Curved Rod
1.6 Gallon Per Flush Elongated Toilets
China Stool, Tank, & Lid
Square China Sinks with Overflows & Pop-Up Drains
Bevel Edge Mirrors
Empire Brushed Nickel Faucets
Anti-Scald Valves on Showers & Tubs

Cabinetry

KCMA
Premium Mission Cabinet Doors with Full Overlay
Premium Cabinet Face Frames & Stiles
Brushed Nickel Cabinet Hardware
Hidden Cabinet Hinges
30"/36" Staggered Overhead Cabinets
Base & Wall Cabinets with Adjustable Shelves
100# Undermount Soft Close Drawer Guides
Laminate Countertops with Crescent Edge
4" Laminate Backsplash
36" High Vanities

Bedrooms

Wire Shelving in Closets
Switched Light in All Walk-In Closets

Flooring

Take Away Shaw Carpet with ShawGuard Carpet Protector
Rebond Carpet Pad with Tackstrip Carpet Installation
LuxFlor No-Wax Vinyl Floor Coverings

Utilities

100 AMP Electrical Service
Plumb & Wire for Washer
Wire & Vent for Dryer
Water Shut Offs Throughout
Main Water Shut-Off Valve
One Exterior Water Faucet
30 Gallon Electric Hot Water Heater with Pan
Air Ready Gas Furnace
5-Wire Thermostat
Copper Wiring Throughout

Insulation

Floor R-11 Fiberglass Insulation
Walls R-19 Fiberglass Insulation
Ceiling R-30 Avg. Blown Insulation
**Spacing for Framing Members may vary due to Design Requirements

CUSTOMER CONTACT

Notes:
