

PRINTABLE INFO SHEET

Series: Edge
Model: 3W1801-P

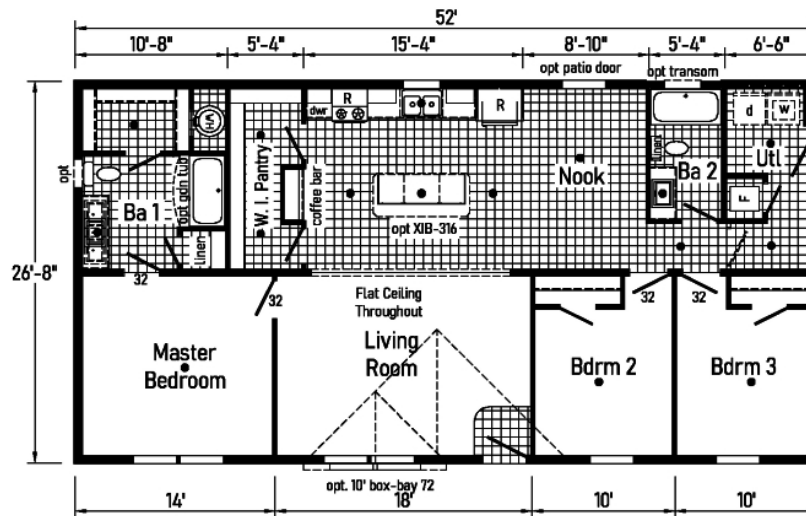

3W1801-P 28x52 Approx. 1387 Sq. Ft.

● = Std. can light
R = Std. 30/36 staggered overhead

Westlake Edge

Builder: midcountry Homes	Address: 337 Liberty Street Dorchester, WI 54425	Callout: 28x52	Revisions:	Scale: 1/8" = 1'-0"	Date: 07/23/2023	Client: -	Model/Eng. No.: 3W1801-P LIT
Title: Literature			Drawn By: OY	Reference: NONE	Dir.: -	S/N:	Pg.: -

About This Model

Style: Ranch / Bedrooms: 3 / Bathrooms: 2 / Square Feet: 1387

CUSTOMER CONTACT

Notes:

PRINTABLE INFO SHEET

Series: Edge
Model: 3W1801-P



Standards & Features

Interior

Primed Drywall Throughout Orange Peel Finish
8'-0" Flat Ceiling Orange Peel Finish
Recessed LED Lights
3-Panel Barnwood Shaker Interior Doors
Pre-Hung Doors with Mortise Hinges
Metal Interior Passage Sets
Window Valances
1" Mini Blinds Throughout
Smoke Detectors with Battery Back-Up
Wire Shelving in Closets
Barnwood Wrapped Mouldings Throughout

Exterior

Black Light at Front and Rear Door
Vinyl Dutch Lap Siding
Vinyl Insulated Windows with Low-E Glass
Lineals Front Door Side
GFI-Protected Exterior Receptacle at Each Exterior Door
O.S.B. Roof & Sidewall Sheathing
Fixed Roof
12" Overhangs and Eaves (Ranch)
4" Overhangs and 12" Eaves (Single)
3-Tab Shingles
Ridge Vent Roof Ventilation System
Ice Shield
3/0x6/8 Fiberglass 6-Panel Front and Rear
Door w/ Deadbolt Keyed Alike Locksets

Construction

Transverse Floor System on 16" Center**
3/4" OSB Decking**
2x6 Floor Joist on 14 and 28 Wide Models

Construction (continued)

2x8 Floor Joists on 16 Wide Models
2x6 Exterior Walls on 16" Center**
82" Window Headers
30# Roof Load

Kitchen

Empire Brushed Nickel High Rise Faucet
Stainless Steel Sink 33x22x8
One USB Receptacle
30" Black Free-Standing Gas Range
Power Range Hood with Fan and Light
18 Cu. Ft. Black Frost-Free Top/Bottom Refrigerator

Baths

60" Fiberglass Tub/Showers
Tub/Shower Curtain and Curved Rod
Dual Flush Hi-Rise Toilets
China Stool, Tank, and Lid
Square China Sinks with Overflows and Pop-Up Drains
Bevel Edge Mirrors
Empire Brushed Nickel Faucets
Anti-Scald Valves on Showers and Tubs

Cabinetry

KCMA Certified Cabinets
Staggered Overhead Cabinets
Barnwood Wrapped Mission Cabinet Doors with Full Overlay
Barnwood Wrapped Cabinet Face Frames and Stiles
Brushed Nickel Cabinet Pulls Hardware
Soft Close Hidden Cabinet Door Hinges
Base and Wall Cabinets with Adjustable Shelves
100# Undermount Soft Close Drawer Guides
Laminate Countertops with Crescent Edge

CUSTOMER CONTACT

Notes:

PRINTABLE INFO SHEET

Series: Edge
Model: 3W1801-P



Standards & Features (continued)

Cabinetry (continued)

4" Laminate Backsplash

36" High Vanities

Bedrooms

Wire Shelving in Closets

Switched Light in All Walk-In Closets

Egress Windows

Flooring

Take Away Shaw Carpet with ShawGuard Carpet Protector

Rebond Carpet Pad with Tackstrip Carpet Installation

Shaw No-Wax Vinyl Floor

Utilities

100 AMP Electrical Service

Plumb and Wire for Washer

Wire and Vent for Dryer

Water Shut Offs Throughout

Main Water Shut-Off Valve at Utility

One Exterior Water Faucet (Frost Free)

30 Gallon Electric Water Heater with Pan

Gas Furnace

5-Wire Thermostat

Copper Wiring Throughout

Insulation

Ceiling R-30 Avg. Blown Insulation

Walls R-19 Fiberglass Insulation

Floor R-11 Fiberglass Insulation

**Spacing for Framing Members may vary
due to Design Requirements

CUSTOMER CONTACT

Notes:
